

Cover Sheet To The

APPENDIX D-4

Beneficiary Eligible Mitigation Action Certification

Submitted by Beneficiary Confederated Tribes and Bands of the Yakama Nation

For the Yakama Nation's Round 2 School Bus Replacement Project

BENEFICIARY ELIGIBLE MITIGATION ACTION CERTIFICATION

Beneficiary _____

Lead Agency Authorized to Act on Behalf of the Beneficiary _____
(Any authorized person with delegation of such authority to direct the Trustee delivered to the Trustee pursuant to a Delegation of Authority and Certificate of Incumbency)

Action Title:	
Beneficiary's Project ID:	
Funding Request No.	<i>(sequential)</i>
Request Type: (select one or more)	<input type="checkbox"/> Reimbursement <input type="checkbox"/> Advance <input type="checkbox"/> Other (specify): _____
Payment to be made to: (select one or more)	<input type="checkbox"/> Beneficiary <input type="checkbox"/> Other (specify): _____
Funding Request & Direction (Attachment A)	<input type="checkbox"/> Attached to this Certification <input type="checkbox"/> To be Provided Separately

SUMMARY

Eligible Mitigation Action	<input type="checkbox"/> Appendix D-2 item (specify): _____
Action Type	<input type="checkbox"/> Item 10 - DERA Option (5.2.12) (specify and attach DERA Proposal): _____
Detailed Description of Mitigation Action Item Including Community and Air Quality Benefits (5.2.2):	
Estimate of Anticipated NOx Reductions (5.2.3):	
Identification of Governmental Entity Responsible for Reviewing and Auditing Expenditures of Eligible Mitigation Action Funds to Ensure Compliance with Applicable Law (5.2.7.1):	
Describe how the Beneficiary will make documentation publicly available (5.2.7.2).	
Describe any cost share requirement to be placed on each NOx source proposed to be mitigated (5.2.8).	
Describe how the Beneficiary complied with subparagraph 4.2.8, related to notice to U.S. Government Agencies (5.2.9).	

If applicable, describe how the mitigation action will mitigate the impacts of NOx emissions on communities that have historically borne a disproportionate share of the adverse impacts of such emissions (5.2.10).

ATTACHMENTS
(CHECK BOX IF ATTACHED)

- Attachment A Funding Request and Direction.
- Attachment B Eligible Mitigation Action Management Plan Including Detailed Budget and Implementation and Expenditures Timeline (5.2.4).
- Attachment C Detailed Plan for Reporting on Eligible Mitigation Action Implementation (5.2.11).
- Attachment D Detailed cost estimates from selected or potential vendors for each proposed expenditure exceeding \$25,000 (5.2.6). [Attach only if project involves vendor expenditures exceeding \$25,000.]
- Attachment E DERA Option (5.2.12). [Attach only if using DERA option.]
- Attachment F Attachment specifying amount of requested funding to be debited against each beneficiary's allocation (5.2.13). [Attach only if this is a joint application involving multiple beneficiaries.]

CERTIFICATIONS

By submitting this application, the Lead Agency makes the following certifications:

1. This application is submitted on behalf of Beneficiary _____, and the person executing this certification has authority to make this certification on behalf of the Lead Agency and Beneficiary, pursuant to the Certification for Beneficiary Status filed with the Court.
2. Beneficiary requests and directs that the Trustee make the payments described in this application and Attachment A to this Form.
3. This application contains all information and certifications required by Paragraph 5.2 of the Trust Agreement, and the Trustee may rely on this application, Attachment A, and related certifications in making disbursements of trust funds for the aforementioned Project ID.
4. Any vendors were or will be selected in accordance with a jurisdiction's public contracting law as applicable. (5.2.5)
5. Beneficiary will maintain and make publicly available all documentation submitted in

support of this funding request and all records supporting all expenditures of eligible mitigation action funds subject to applicable laws governing the publication of confidential business information and personally identifiable information. (5.2.7.2)

DATED: August 21, 2019

Elizabeth Sanchey, Program Manager

[NAME]

[TITLE]

SIGNATURE: 

Yakama Nation Environmental Management Program

[LEAD AGENCY]

for

Confederated Tribes and Bands of the Yakama Nation

[BENEFICIARY]

ATTACHMENT A

FUNDING REQUEST AND DIRECTION

(Attachment to Appendix D-4, Beneficiary Eligible Mitigation Action Certification, pursuant to Paragraph 5.2 of the Environmental Mitigation Trust Agreement)

Pursuant to the authority granted to _____ to act on behalf of Beneficiary _____ under the Mitigation Trust, _____ directs the Trustee to make the following payments from its subaccount no. _____ 123437-001 _____ to the following payees, for the amounts specified on the dates specified below.

LEAD AGENCY INFORMATION

Beneficiary Name: _____	Lead Agency Contact Person: _____
Lead Agency Name: _____	Lead Agency Email Address: _____
Lead Agency Address: _____	Lead Agency Fax: _____
Lead Agency Phone: _____	Lead Agency TIN: _____

Contact information entered above may correspond to Lead Agency or any authorized person with delegation of such authority to direct the Trustee delivered to the Trustee pursuant to a Delegation of Authority and Certificate of Incumbency

MITIGATION ACTION INFORMATION

Action Title: _____	Funding Request No: _____
Beneficiary's Project ID: _____	

PAYMENTS REQUESTED

(attach additional pages if needed)

Amount	Requested Date	Payee	Request Type

PAYEE CONTACT AND WIRE INFORMATION

(fill out both tables below for each payee and payment identified in "Payments Requested" table on p. 1; attach additional pages if needed)

PAYEE CONTACT INFORMATION

Action Title:	<u>Yakama Nation's Round 2 School Bus Replacement Pr</u>	Beneficiary Project ID:	<u>Yakama Nation's Round 2 School Bus Replacement Pr</u>
Payee Name:	<u>Yakama Nation Environmental Management Program</u>	Payee Contact Person:	<u>Elizabeth Sanchey</u>
Payee Address:	<u>P.O. Box 151, 401 Fort Road, Toppenish, WA 98948</u>	Payee Email Address:	<u>elizabeth_sanchey@yakama.com</u>
Payee Phone:	<u>509-865-5121</u>	Payee Fax:	<u></u>
Payee TIN:	<u>91-0576806</u>		

Payment Amount	Requested Date	Request Type
\$394,215.00	November 13, 2019	Advance

WIRE INFORMATION

Receiving Bank Name:	<u></u>	
Receiving Bank Branch:	<u></u>	
Receiving Bank Address:	<u></u>	
Bank Swift ID:	<u></u>	National Routing No. / Bank ABA Number <i>(Sort Code, BLZ)</i>
Amount of Wire:	<u></u>	
Message to Payee:	<u></u>	
Instructions to Receiving Bank:	<u></u>	
For Credit to:	<u></u>	
Other Special Instructions:	<u>Please pay by check</u>	

[Signature Block]

DATED: August 21 2019

Elizabeth Sanchey, Program Manager

Yakama Nation Environmental Management Program (Lead Agency)

Confederated Tribes and Bands of the Yakama Nation (Beneficiary)

SIGNATURE:

E. Sanchey

EXHIBIT 1

Detailed Description Of Mitigation Action Item Including Community And Air Quality Benefits (5.2.2)

The Confederated Tribes and Bands of the Yakama Nation (“Yakama Nation”) is pleased to submit the Yakama Nation’s Round 2 School Bus Replacement Project (“Project”) under the Environmental Mitigation Trust Agreement for Indian Tribe Beneficiaries dated November 30, 2018 (“Indian Tribe Trust Agreement”). The Project is primarily submitted under Section 2(e)(1) of Appendix D-2 to the Indian Tribe Trust Agreement. The Project also includes a light duty zero emission vehicle (“ZEV”) component under Section 9(c)(1) of Appendix D-2.

The Yakama Nation’s Project would deploy two all new diesel buses servicing the Yakama Nation’s tribal school. The new school buses will both be new Thomas rear engine diesel school buses, Model Profile: Thomas Built Buses Saf-T-Liner HDX 141YS. The eligible vehicles they are replacing is a 2005 Thomas school bus, License Plate I-02833, VIN 4UZAAXDG55CU38449; and a 2005 Thomas school bus, License Plate I-02832, VIN 4UZAAXCS85CU30951. These buses are each an “Eligible Bus” under Section 2 of Appendix D-2 to the Indian Tribe Trust Agreement because they are each a diesel bus that is older than 2009 with a Gross Vehicle Weight Rating greater than 14,001 lbs. Each replaced bus will be rendered inoperable (meaning, at a minimum, it will have a 3-inch hole cut in the engine block and its frame rails will be cut completely in half) and the remaining usable parts will be recycled or scrapped.

The Yakama Nation’s Project also includes a light duty ZEV component. Section 9 of Appendix D-2 permits beneficiaries to use up to 15% of their funds “on the costs necessary for, and directly connected to, the acquisition, installation, operation and maintenance of new light duty zero emission vehicle supply equipment for projects specified below.” The Yakama Nation intends to use up to that full amount to install a light duty ZEV charging station, with the final number of chargers dictated by the approved budget and actual installation costs. For its first round project under the Indian Tribe Trust Agreement, the Yakama Nation is planning to install two Level 2 chargers, the ChargePoint CT4025-GW1 Gateway Unit and the ChargePoint CT4025 unit. For the Project, the Yakama Nation is planning to add a third charger (another ChargePoint CT4025 unit) to that charging station.

The Yakama Nation believes the Project will result in several significant air quality and community benefits, including but not limited to substantially reduced tailpipe emissions (including NOx), reduced greenhouse gas emissions, better vehicle performance and propulsion system durability, and increased comfort for the operator and passengers.

EXHIBIT 2

Estimate Of Anticipated NOx Reductions (5.2.3)

The Yakama Nation does not have exact information on the NOx emissions from the vehicle it is replacing. Accordingly, the Yakama Nation used the Diesel Emissions Quantifier (DEQ) tool provided by the United States Environmental Protection Agency to calculate the anticipated NOx reduction.¹ The Yakama Nation has four school buses it is seeking to replace, and has the following estimates for the average annual mileage and idling time for those four vehicles: the first school bus will average about 36,500 miles per year and about 130 hours of idling per year, the second school bus will average about 31,286 miles per year and about 130 hours of idling per year, the third school bus will average about 28,679 miles per year and about 130 hours of idling per year, and the fourth school bus will average about 26,000 miles per year and about 118 hours of idling per year. The Yakama Nation took the average of these 4 buses—equal to annual mileage of 30,616 miles and annual idling time of 127 hours—and input 4 “average” buses into the DEQ tool. In order to calculate the diesel fuel input, the Yakama Nation multiplied the DEQ tool’s default annual fuel (1,360 gallons) times the Yakama Nation’s average mileage (30,616 miles) divided by the DEQ tool’s default annual mileage (14,084 miles) to come up with 2,956 gallons. The Yakama Nation used these numbers to run a calculation on annual NOx for the buses with a 2005 model year, which resulted in 0.819 annual tons of NOx, and to run a calculation on annual NOx for the buses with a 2017 model year, which resulted in 0.085 annual tons of NOx. The result is an annual NOx reduction of 0.734 tons per year, or 1,468 pounds per year, for the four buses.

As such, for the Yakama Nation’s Project involving the replacement of two school buses, the Yakama Nation anticipates an annual NOx reduction of 734 pounds per year.

¹ The DEQ Tool was accessed at this website on or before December 2017:
<https://www.epa.gov/cleandiesel/diesel-emissions-quantifier-deq>

EXHIBIT 3

Describe How The Beneficiary Will Make Documentation Publicly Available (5.2.7.2)

The Yakama Nation will maintain and make publicly available all documentation submitted in support of its funding request and all records supporting all expenditures of any funds it receives, subject to applicable laws governing the publication of confidential business information and personally identifiable information. In response to any inquiry from the public to request additional information and documents related to the funding request and expenditure of funds, such documentation shall be made publicly available by appointment for review at tribal headquarters. In addition, under Section 5.3 of the Indian Tribe Trust Agreement the Trustee will post on its public-facing website the semiannual reports submitted to the Trustee by the Yakama Nation.

The Yakama Nation's certification of Section 7 of its Certification for Beneficiary Status Under Environmental Mitigation Trust Agreement is subject to the Yakama Nation's governing policies on the release of its records, which establishes the Yakama Nation's position on the procedures for making records publicly available and on the handling of requests by outside parties for the release of various categories of tribal records and the procedures for handling such requests. The Yakama Nation protects from disclosure privileged and protected information.

EXHIBIT 4

Describe How The Beneficiary Complied With Subparagraph 4.2.8, Related To Notice To U.S. Government Agencies (5.2.9)

The Yakama Nation certifies that it has been more than 30 Days since the Yakama Nation was deemed a Beneficiary pursuant to subparagraph 4.0.2.1 of the Indian Tribe Trust Agreement, and that the Yakama Nation has not provided a copy of the Indian Tribe Trust Agreement with Attachments to any Federal Agency since no Federal Agency has notified the Yakama Nation of its interest thereunder. The Yakama Nation further certifies that it will provide a copy of the Indian Tribe Trust Agreement with Attachments to the U.S. Department of the Interior, the U.S. Department of Agriculture, and any other Federal Agency that has custody, control, or management of land within or contiguous to the territorial boundaries of the Yakama Nation and has notified the Yakama Nation of its interest thereunder, explaining that the Yakama Nation may request Eligible Mitigation Action funds for use on lands within that Federal Agency's custody, control, or management (including, but not limited to, Clean Air Act Class I and II areas), and setting forth the procedures by which the Yakama Nation will review, consider, and make a written determination upon each such request, within 30 days of receipt of such notice.

ATTACHMENT B

Eligible Mitigation Action Management Plan Including Detailed Budget And Implementation And Expenditures Timeline (5.2.4)

PROJECT SCHEDULE AND MILESTONES

The Yakama Nation estimates the Yakama Nation's Project will conclude about 18 months after the funds are distributed, in May 2021. It can be broken into the following steps:

Step 1. Trustee Award (3 months) [November 2019]

The Yakama Nation's Project will not begin until the Trustee has distributed funds to the Yakama Nation. The Yakama Nation assumes this will occur by November 2019. The contractual application fee will be expended when the funds are distributed.

Step 2. Bus Procurement and delivery (14 months) [April 2021]

This step will include purchasing the new buses and rendering the old buses inoperable. The Yakama Nation anticipates a bus delivery time of about 9-12 months after the bus is ordered. The funds for the bus will be expended when the bus is ordered, and the school bus accessories will be purchased when the bus is delivered. Once the new bus is delivered, the bus being replaced will be rendered inoperable, and the funds for that will be expended at that time. Any delivered vehicles will be registered and insured by the Yakama Nation.

Step 3. Light Duty ZEV Installation (14 months) [April 2021]

This step involves finalizing plans for the charging station and seeking the necessary permits from local authorities to install the systems. During this step, the Yakama Nation will be working with Yakama Power to develop a site and installation plan for the charging stations, including any site engineering (such as civil, electrical, and mechanical), construction, and equipment installation. The costs for the charging infrastructure equipment will be expended when the parts are ordered once the site design is complete. The costs for the charging infrastructure installation will be expended as infrastructure is completed.

The Yakama Nation anticipates that steps 2 and 3 can mostly be performed simultaneously.

Step 4. Project Completion (1 month) [May 2021]

Once the replaced bus is rendered inoperable and the charging station is installed, the Yakama Nation will issue a final report summarizing implementation and will close out the project with the Trustee. Assuming that the award occurs in November 2019, the Yakama Nation estimates project completion will occur in May 2021. The contractual project fee will be expended when the project is complete.

PROJECT BUDGET

Eligible Mitigation Action and Mitigation Action Expenditure Categories	Item	Cost	Qty.	Total
D-2 Section 2(e)(1) - Government-Owned Eligible Buses	Thomas Built HDX 140YS	\$180,972	2	\$361,944
	Bus Accessories	\$5,000	2	\$10,000
<i>Subtotal (excluding light duty ZEV):</i>				\$371,944
D-2 Section 9(c)(1) - Light Duty ZEV, Gov't Property	ChargePoint CT4025	\$7,695	1	\$7,695
<i>Subtotal (including light duty ZEV):</i>				\$379,639
Administrative Expenditures	Personnel (\$20/hr)	\$20	150	\$3,000
	Fringe benefits	40%	\$3,000	\$1,200
	General office supplies	Item cost bundled	Bundled estimate	\$400
	Contractual - application	\$350	9.9	\$3,465
	Contractual - project	\$350	20	\$7,000
	Construction	Item cost bundled	Bundled estimate	\$1,500
	Insurance	Item cost bundled	Bundled estimate	\$1,000
	Other - bus salvage fee	\$5,000	2	\$10,000
<i>Subtotal:</i>				\$407,204
Cost share correction - to be accomplished by reducing funding of the light duty ZEV project and/or internal administrative costs				\$(12,989)
PROJECT TOTAL				\$394,215

ATTACHMENT C

Detailed Plan For Reporting On Eligible Mitigation Action Implementation (5.2.11)

No later than six months after the Yakama Nation receives its first disbursement of Trust Assets, and thereafter no later than January 30 (for the preceding six-month period of July 1 to December 31) and July 30 (for the preceding six-month period of January 1 to June 30) of each year, the Yakama Nation shall submit to the Trustee a semiannual report describing the progress implementing the Yakama Nation's Project during the six-month period leading up to the reporting date (including a summary of all costs expended on the Eligible Mitigation Action through the reporting date).

The Yakama Nation's reports shall include a complete description of the status (including actual or projected termination date), development, implementation, and any modification of the Yakama Nation's Project. The Yakama Nation does not anticipate that these reports will be onerous because the Project primarily consists of obtaining two new buses. If necessary, the Yakama Nation will engage the services of external vendors to review and/or audit these reports. These reports shall be signed by an official with the authority to submit the report for the Yakama Nation and will contain an attestation that the information is true and correct and that the submission is made under penalty of perjury.

ATTACHMENT D

Detailed Cost Estimates From Selected Or Potential Vendors For Each Proposed Expenditure Exceeding \$25,000 (5.2.6)

Attachment D includes a cost estimate for the new buses from Schetky Northwest Sales, the local Thomas school bus dealer.

Attachment D also includes a contractual fee from the Askman Law Firm, LLC setting forth fees incurred thus far in preparing the application along with an estimate for future project support efforts.

For the charging station, the Yakama Nation intends to coordinate work with its first round project, and as such does not anticipate having any additional installation charges. The cost estimates for the other budget items – including the ChargePoint CT4025 at \$7,695, the bus accessories at \$5,000, and the bus salvage fee of \$5,000 – are less than \$25,000 so are not attached.



Prepared For:
 Clifford Smiscon
 Yakama Nation Tribal School
 509-406-9765

Dealer Sales:
 Scott Meyer
 509-492-6049
 scottm@schetkynw.com

151 Fort Road
 Toppenish, WA 98948

4111 E. B Circle
 Pasco, WA 99301

Quote Number:
 352293

Quote Date:
 2/7/2019

Quote Expires:
 8/24/2019

Revised 5/20/2019
 Revised 7/25/2019

Model Profile: Thomas Built Buses Saf-T-Liner HDX 141YS

Product Type: Type - D Rear Engine
Year: 2020
Chassis Model: 141YS
Chassis MFG: THOMAS
GVWR: 36,200lbs
Passenger Capacity: 44 Passengers + Driver with 3PT Lap & Shoulder Belts
Headroom: 78
Wheelbase: 277
Brake Type: AIR DISC W/REAR AIR SUSPENSION
Engine Type: DETROIT DIESEL DD8 300HT DIESEL, 6 Cyl, 300 HP, 2600 RPM
Fuel Type: DIESEL
Fuel Tank Capacity: 100
Transmission Type: ALLISON 3000PTS
Axle, Front: 13200-lb Capacity
Axle, Rear: 23000-lb Capacity
Tires, Front: HANKOOK-11R22.5 16PLY AH37
Tires, Rear: HANKOOK-11R22.5 16PLY DH37
Suspension Front: STANDARD SPRING
Suspension Rear : HENDRICKSON "COMFORT AIR" SINGLE AXLE AIR SUSPENSION-23K AXL

Total for 1 complete unit(s): **\$ 180,972.00**

F.O.B., Toppenish, WA

Price Includes No Taxes That May Apply to Yakama Nation

Estimated Delivery: 220-260 Days ARO

Total Unit Quantity _____

Terms and Conditions: Net 30 Days

Quote Expires: 8/24/2019

By signing below, you are acknowledging the specifications listed are complete and accurate. Order will be placed using the specifications listed.

Customer Signature: _____ **Date:** _____
Authorized Signature

Dealer Sales: _____ **Date:** _____
Authorized Signature

Please Forward All Remittances to Our Corporate Office:
 8430 NE Killingsworth Street
 Portland, OR 97220

Includes the Following Equipment:

BODY

ACCESSORIES

- 1 [B210510000] DRIVER'S STORAGE BOX LOCATED OVER DRIVER'S WINDOW
- 1 [B210512000] LOCK - DRIVER'S STORAGE BOX
- 1 [B552300000] PROP ROD - ACCESS DOOR ABOVE WINDSHIELD
- 1 [B596810000] LUGGAGE COMPARTMENT - THROUGH, DELUXE, 125" (Includes Gas Springs & Locks)

CERTIFICATION/SAFETY

- 1 [B202001000] FIRE EXTINGUISHER - 5 LB.
- 1 [B209010000] REFLECTORIZED TRIANGLES - 3 BENEATH FIRST SEAT ON LEFT SIDE
- 1 [B287599999] CROSSVIEW MIRROR INCLUDED IN REARVIEW MIRROR ASSEMBLY
- 1 [B289903000] ROSCO INTEGRATED STYLE - REMOTE CONTROL HEATED MIRROR
- 1 [B294030000] AIR CLUSTER LED / STROBE STOP SIGNAL
- 1 [B525235002] ROOF HATCH-SPEC PROLO GRAY (W/BUZZER FEATURE),ENGLISH (2)

DOORS

- 1 [B515500000] 24" SIDE EMERGENCY DOOR LS
- 1 [B515570000] SIDE EMERGENCY DOOR - RIGHT SIDE, CENTER, 78" HEADROOM
- 1 [B518206000] VANDALOCK - AIR-OPERATED OUTWARD OPENING ENTRANCE DOOR
- 2 [B518602000] VANDALOCK - SIDE EMERGENCY DOOR WITH INTERLOCK & BARREL BOLT
- 1 [B518800000] VANDALOCK - REAR PUSHOUT WINDOW, WITH DAVENPORT SHELF
- 1 [C340202000] STEPWELL GUARD

ELECTRICAL - BODY

- 1 [B216010000] TWO(2)DEFROSTER FANS MOUNTED OVER CENTER WINDSHIELD
- 1 [B258001400] OUTSIDE SPEAKER HORN - CHASSIS-MOUNTED
- 1 [B259120000] VIRTUAL TECHNICIAN HU CONNECTIVITY
- 1 [B259205000] CELLULAR PHONE POWER OUTLET REAR WALL OF SWITCH CABINET
- 1 [B260300008] SPEAKERS - EIGHT (8)
- 1 [B260405001] RADIO - AM/FM DEA510 DELPHI, TRANSIT W/PAGE
- 1 [B302004000] BREAKERS - MANUAL RESET
- 1 [B308006012] COMPARTMENT LIGHTS(6)-125" THROUGH,DELUXE COMPART
- 1 [B320200141] LED DOME LIGHTS
- 1 [B322200000] DOME LIGHTS WIRED TO BATTERY
- 1 [B323005000] LED DRIVER'S DOME LIGHT
- 1 [B329002000] STEP LIGHT SWITCH (IGNITION ON)
- 1 [B329014000] FLUSH MTD EXTERIOR LED LIGHT-ENT DOOR
- 1 [B333108000] 7" LED DIRECTIONAL LIGHTS - FRONT
- 1 [B336002000] LAMPS-STOP/TAIL/DIRECTIONAL AMBER/REVERSE LED
- 1 [B339302000] LAMPS-STOP/TAIL 4"FLUSH-MOUNT LED
- 1 [B342200002] SIDE DIRECTIONAL-PIN AMBER TURN,CENTER FRONT WHEEL
- 1 [B342200012] SIDE DIRECTIONAL-PIN AMBER TURN,CENTER REAR WHEEL
- 1 [B358028006] LED WARNING LIGHTS - STROBE,FOUR(4)AMBER & FOUR (4) RED LENS
- 1 [B364053000] MARKER/ID LAMPS - LED PIN TYPE
- 1 [B364054000] MID-MARKER LAMPS - LED PIN TYPE
- 1 [B368004000] FOG LIGHTS - TWO (2) QUARTZ HALOGENS IN ABS BLACK CASINGS
- 1 [B380504000] RECEPTACLE - REAR, ENGINE HEATER
- 1 [B383300000] NOISE SUPPRESSION SWITCH
- 1 [B384002000] LUGGAGE COMPARTMENT LIGHT SWITCH (4) THRU, DELUXE, 95"/125"
- 1 [B579101000] STATIC VENT FRONT - TRANSIT, STANDARD
- 1 [B585738000] ELECTRIC OPERATING CROSSING CONTROL ARM
- 1 [B599000002] BATTERY HOLD DOWN BRACKET - STANDARD 3 BATTERY
- 1 [B599063000] BATTERY BOX - STANDARD

EXTERIOR

- 1 [B230000000] AIR HORN - BENEATH FLOOR
- 1 [B537000000] COVER LOCK
- 1 [B542002000] 20 GAUGE SMOOTH SIDE SHEETS
- 1 [B548801000] BRACKET - MOUNTING, LICENSE PLATE, FRONT
- 1 [B560000000] SEALING, EXTERIOR JOINT EDGE
- 1 [B566001000] MUD FLAPS - FRONT, RUBBER, 15"W WITH LOGO
- 1 [B566005000] REAR RUBBER MUD FLAPS 22.5W W/LOGO
- 1 [B571001000] FENDERETTES - FOUR (4)

HVAC

- 1 [B403004000] HEATER 15,000 BTU - DRIVER'S COMPARTMENT

- 1 [B412005030] 50,000 BTU HEATER - 5TH SECTION LEFT SIDE
- 1 [B412008030] 50,000 BTU HEATER - 8TH SECTION LEFT SIDE
- 1 [B412016030] 50,000 BTU HEATER - AGAINST REAR WALL, RIGHT SIDE
- 1 [B412107000] SERIES HEATER CONNECTION - REAR HEATERS THREE(3)
- 1 [B415416000] HEATER HOSE - HI-MILER, RIGHT SIDE, REAR HEATER
- 1 [B420507000] PLUMBING AT SIDE DOOR WITH PLYWOOD FLOOR
- 1 [B420603000] CONSTANT TORQUE CLAMPS - THREE (3) REAR UNDERSEAT HEATERS
- 1 [B429000000] SIDE DOOR RAMP OVER HEATER HOSE
- 1 [B816011000] MCC AC-106K/120K, FREE BLOW-SKIRT MT CONDENSORS
- 1 [B840204000] CONDENSER STACKING KIT OPTION

INTERIOR

- 1 [B150609032] BLACK KORSEAL STEP TREADS/NOSING - OUTWARD OPENING ENTRY DOOR
- 1 [B153520141] DARK GRAY VINYL FLOOR WITH 13" CENTER AISLE
- 1 [B158000141] PLYWOOD FLOOR - 5/8" THICKNESS
- 1 [B531000141] 78" HEADROOM
- 1 [B533603141] ACOUSTIC HEADLINING - COMPLETE WITH POLYESTER INSULATION
- 1 [B560600000] SEALANT - PLYWOOD FLOOR EDGES
- 1 [B575513000] ASSIST RAIL - EXTRA, OUTWARD OPENING ENTRANCE DOOR

PAINT/LETTERING

- 1 [B132401000] PAINT STANDARD SASH FLAT BLACK
- 2 [B134000000] RED HANDLE - EMERGENCY DOOR(S)
- 1 [B143800000] LOGO - POWERED BY DETROIT
- 1 [B147502000] YELLOW REFLEXITE - 1", PERIMETER OF REAR BUS BODY
- 1 [B147503000] YELLOW "SCHOOL BUS" SIGN - FRONT HOOD
- 1 [B147504000] YELLOW "SCHOOL BUS" SIGN - REAR HOOD
- 2 [B147511000] YELLOW REFLEXITE - PERIMETER OF EMERG DOOR, 24" W (78" HR)
- 1 [B147513000] YELLOW REFLEXITE - PERIMETER OF REAR PUSHOUT WINDOW
- 1 [B147538002] REFLECTIVE TAPE-ROOF HATCH WHITE(2)
- 1 [B147604141] YELLOW REFLEXITE - 2", BELT LINE - BOTH SIDES OF BUS BODY
- 1 [D50601F141] PAINT-EXTERIOR ROOF WHITE 6"
- 1 [D5061SC141] PAINT-EXT WDO AREA SAME AS BODY
- 1 [D506347000] PAINT-EXT GRD RAIL @ WINDOW BLACK
- 1 [D506447000] PAINT-EXT GRD RAIL @ SEAT BLACK
- 1 [D506547000] PAINT-EXT GRD RAIL @ FLOOR BLACK
- 1 [D506647000] PAINT-EXT GRD RAIL @ SKRT BLACK
- 1 [D506747002] PAINT-EXT BUMPERS FRT/RR BLACK
- 1 [D510646141] PAINT-SOLID COLOR YELLOW

SEATS

- 1 [A000000165] FREEDMAN COMMERCIAL SEATING ALERT
- 1 [B610000095] BELT-ELR SHOULDER/PUSH BUTTON LAP
- 1 [B620001077] BARRIER STORAGE POUCH, RIGHT SIDE AT ENTRANCE DOOR
- 1 [B620039090] KICK PLATE/MODESTY PANEL-39"VERT, WALL-MTD BARRIER,RT SIDE
- 10 [B637999040] FREEDMAN FAM 3PTA 2 PASSENGER WALL MOUNT LS
- 1 [B640139107] 39" BARRIER - VERTICAL,WALL MOUNT 45" H LS
- 1 [B640139200] 39" BARR-VERT,WALL MT 45"H RS
- 1 [B640139207] 39" BARRIER - VERTICAL,WALL MOUNT 45" H RS
- 1 [B640239000] 39"8DEG BARR-REV. WALL-MT 45"H
- 10 [B647999040] FREEDMAN FAM 3PTA 2 PASSENGER WALL MOUNT RS
- 4 [B660008121] DURASEAT BLUE UPHOLSTERY-45"HIGH RECESSED BARRIER
- 1 [D900104000] BACK-NATIONAL DRV'S SEAT
- 1 [D900302001] ARMREST NATIONAL DRVR'S ST. BOTH SIDES
- 1 [D900403005] UPH DR.ST.BLUE FABRIC INSERT KEVLAR TRIM NATIONAL
- 1 [D900503007] PEDESTAL-NATIONAL AIR W/2 SHOCKS
- 1 [D900602000] COVER PEDASTAL NATIONAL DR.ST.
- 1 [D900802002] RETAINER NATIONAL DR.ST.BELT
- 1 [D900902000] POUCH-DR.ST.STORAGE
- 1 [D901200003] RISER-DRIVERS SEAT, NATIONAL NONE
- 1 [D980408266] KEVLAR BLUE UPH - S3C DAVENPORT
- 1 [D984536036] S3C 36"/36" DAVEN W/3-PT BELTS

WARRANTY

- 1 [B28WAR-001] EXTENDED BDOY WARRANTY-3 YR 50,000 MILES

WINDOWS/GLASS

- 1 [B161101141] TINTED TEMPERED GLASS - COMPLETE
- 1 [B162009000] TINTED WINDSHIELD WITH 5" BAND FOR MVP-ER, ER TRANSIT

- 23 [B700701002] TINT TEMP GLASS-COMP (28.5")
- 2 [B700702002] TINT TEMP GLASS-COMP(28.5")+10
- 1 [B700704002] TINT TEMP GLASS-COMP(28.5")-8
- 1 [B700900003] WINDOW STOPS (12")

OTHER

- 1 [B260000000] VIRTUAL TECHNICIAN/DETROIT CONNECT ACCESS - 5 YEAR

CHASSIS

AXLES AND SUSPENSIONS

- 1 [C145622000] AXLE - REAR, DANA 22060S, 5.57 RATIO
- 1 [C207210000] **ELECTRONIC STABILITY CONTROL**
- 1 [C386006000] SYNTHETIC LUBE STANDARD W/FRONT AXLE
- 1 [C443000000] HENDRICKSON "COMFORT AIR" SINGLE AXLE AIR SUSPENSION-23K AXL

BRAKES

- 1 [C207035000] ANTILOCK BRAKES - MERITOR/WABCO
- 1 [C207037000] AIR ANTI-LOCK DISC BRAKES
- 1 [C600001000] PARKING BRAKE INTERLOCK

CHASSIS EQUIPMENT

- 1 [C114400000] SCHRAEDER VALVE LOCATED IN ENGINE COMPARTMENT
- 1 [C114900000] REMOTE AIR RESERVOIR DRAINS - RIGHT SIDE
- 1 [C222800000] ADJUSTABLE PEDAL SYSTEM
- 1 [C250019000] CHASSIS A/C KIT - 05K, 270 AMP ALTER, DETROIT DD8
- 1 [C336504000] 100 GALLON FUEL TANK, BETWEEN THE RAILS, RIGHT HAND FILL
- 1 [C340007277] CHASSIS FRAME RAIL - REG. STRENGTH (50KSI) HDX (277"WB)
- 1 [C340500000] TOW HOOKS, FRONT - TWO (2)

ELECTRICAL - CHASSIS

- 1 [C182900000] TRIPLE 12-VOLT GROUP 31 BATTERIES
- 1 [C184501001] CIRCUIT BREAKERS-MANUAL RESET
- 1 [C362302000] SOLID STATE ELECTRONIC FLASHER FOR HAZARD LIGHTS
- 1 [C367404000] ZONAR GPS PRE-WIRING FOR INSTALLATION

ENGINE AND EQUIPMENT

- 1 [C116400000] AIR DRYER - BENDIX AD9 WITH HEATER
- 1 [C207819000] ENGINE COMPRESSION BRAKE DETROIT DIESEL DD8
- 1 [C221119000] CRUISE CONTROL
- 1 [C221270000] VEHICLE SPEED LIMITING(70 MILES PER HOUR SETTING)
- 1 [C230543000] FUEL/WATER SEPARATOR WITH HEATER
- 1 [C230605000] COOLANT RECOVERY BOTTLE
- 1 [C231610000] 6' BLOCK HEATER ELECTRIC CORD - FRONT/REAR RECEPTACLE
- 1 [C231819000] BLOCK HEATER
- 1 [C245702300] DETROIT DIESEL DD8 - 300 HIGH TORQUE
- 1 [C362900000] MULTI-FUNCTION GAUGE-REAR PANEL

TRANSMISSION AND EQUIPMENT

- 1 [C602808831] ALLISON 3000 PTS TRANSMISSION DD8 300HT
- 1 [C602910831] 6 SPEED SHIFT CONTROL - 3000 PTS TRANSMISSION (DD8)
- 1 [C605000000] ALLISON FUEL SENSE - NONE

WHEELS AND TIRES

- 4 [C528006001] HANKOOK-11R22.5 16PLY DH37
- 2 [C528007001] HANKOOK-11R22.5 16PLY AH37
- 1 [C597100000] TIRE BALANCING
- 6 [C656007000] DISC WHEEL - 8.25 X 22.5, 5H (BLACK)
- 1 [C656701000] HUB-PILOTED WHEEL EQUIPMENT - 23K

STANDARD WARRANTY

Standard DD8 Engine Warranty: 5 years; 100,000 Miles

Standard Allison Transmission Warranty: 5 Years; Unlimited Miles

Standard Thomas Body and Chassis Warranty: 1-5 Years; Unlimited Miles

DEALER ADD On's

EQUIPMENT

- 1 10 Year; 200,000 Mile Detroit Diesel DD8 EW4 (WAI-5R8) Extended Engine Warranty
- 1 Electrical Outlets: 1-110V & 2 USB's each Freedman Seat Location Except 2 Wheel Well Seats
- 1 Install 1800 Watt Inverter and Connect USB/110V Outlets on Seats to Power
- 1 Install 45K Webasto Heater
- 1 Install Dual Port USB/Charger
- 1 Install High Windguard for Stop Arm

- 1 Install Last Row of LED Domes on Separate Switch
- 1 Install Outside Temperature Gauge
- 1 Install Pole Vault Tube in Luggage Compartment
- 1 Install Seon TH6 Trooper Camera System w/ 4 Cameras
- 1 Manuals-Detroit Diesel DD8 (Available Online)
- 1 Set Regen to Zero
- 1 Washington State Legals

Meets all FMVSS requirements in effect at the time of manufacture.

SEATING CAPACITY: 44 + DRIVER

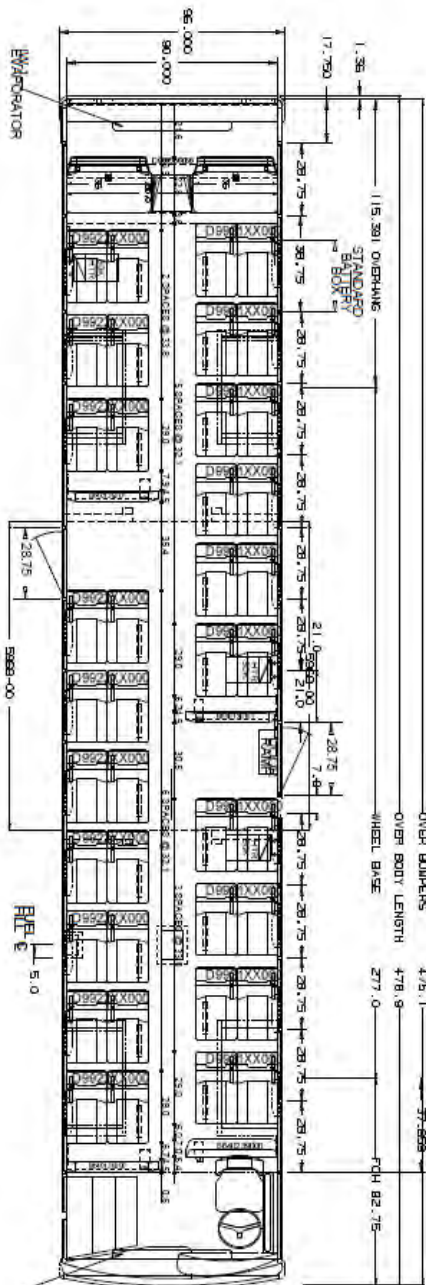
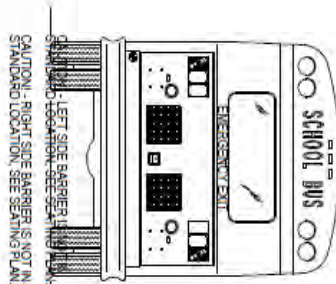
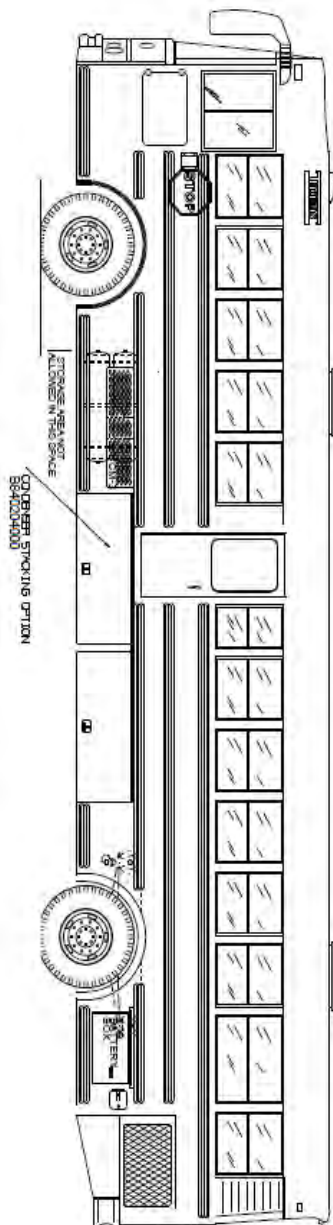

NOTES:
UNIT EQUIPPED WITH PLYWOOD FLOOR
EVAPORATOR

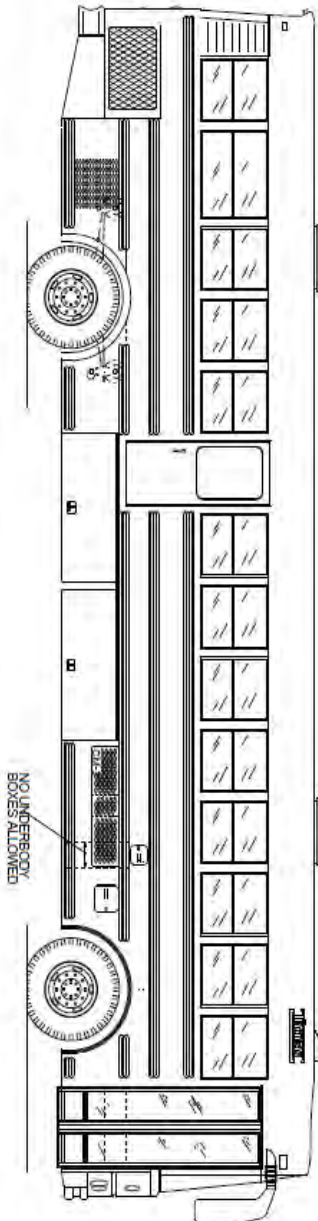
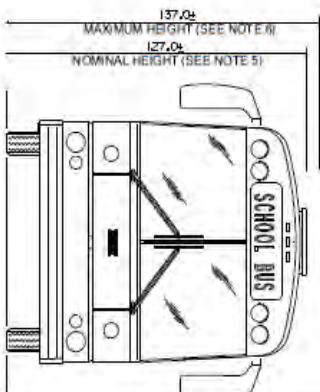

Model: Set-T-Liner HDX
Quote Number: 352293
Locality: WA

ALL DIMENSIONS ARE FOR REFERENCE ONLY

GENERAL NOTES

1. THIS DRAWING IS FOR REFERENCE ONLY AND MAY BE SUBJECT TO CHANGE WITHOUT NOTICE.
2. DIMENSIONS ARE TO CENTERLINE UNLESS OTHERWISE SPECIFIED.
3. DIMENSIONS ARE TO CENTERLINE UNLESS OTHERWISE SPECIFIED.
4. DIMENSIONS ARE TO CENTERLINE UNLESS OTHERWISE SPECIFIED.
5. DIMENSIONS ARE TO CENTERLINE UNLESS OTHERWISE SPECIFIED.
6. DIMENSIONS ARE TO CENTERLINE UNLESS OTHERWISE SPECIFIED.
7. DIMENSIONS ARE TO CENTERLINE UNLESS OTHERWISE SPECIFIED.
8. DIMENSIONS ARE TO CENTERLINE UNLESS OTHERWISE SPECIFIED.
9. DIMENSIONS ARE TO CENTERLINE UNLESS OTHERWISE SPECIFIED.
10. DIMENSIONS ARE TO CENTERLINE UNLESS OTHERWISE SPECIFIED.

ITEM	DESCRIPTION	QTY	UNIT PRICE	TOTAL PRICE
1	SEAT	312	28.8	8985.60
2	SEAT	35.1	21.1	738.61
3	SEAT	33.8	23.8	794.44
4	SEAT	33.8	23.8	794.44
5	SEAT	33.8	23.8	794.44
6	SEAT	33.8	23.8	794.44
7	SEAT	33.8	23.8	794.44
8	SEAT	33.8	23.8	794.44
9	SEAT	33.8	23.8	794.44
10	SEAT	33.8	23.8	794.44
11	SEAT	33.8	23.8	794.44
12	SEAT	33.8	23.8	794.44
13	SEAT	33.8	23.8	794.44
14	SEAT	33.8	23.8	794.44
15	SEAT	33.8	23.8	794.44
16	SEAT	33.8	23.8	794.44
17	SEAT	33.8	23.8	794.44
18	SEAT	33.8	23.8	794.44
19	SEAT	33.8	23.8	794.44
20	SEAT	33.8	23.8	794.44
21	SEAT	33.8	23.8	794.44
22	SEAT	33.8	23.8	794.44
23	SEAT	33.8	23.8	794.44
24	SEAT	33.8	23.8	794.44
25	SEAT	33.8	23.8	794.44
26	SEAT	33.8	23.8	794.44
27	SEAT	33.8	23.8	794.44
28	SEAT	33.8	23.8	794.44
29	SEAT	33.8	23.8	794.44
30	SEAT	33.8	23.8	794.44
31	SEAT	33.8	23.8	794.44
32	SEAT	33.8	23.8	794.44
33	SEAT	33.8	23.8	794.44
34	SEAT	33.8	23.8	794.44
35	SEAT	33.8	23.8	794.44
36	SEAT	33.8	23.8	794.44
37	SEAT	33.8	23.8	794.44
38	SEAT	33.8	23.8	794.44
39	SEAT	33.8	23.8	794.44
40	SEAT	33.8	23.8	794.44
41	SEAT	33.8	23.8	794.44
42	SEAT	33.8	23.8	794.44
43	SEAT	33.8	23.8	794.44
44	SEAT	33.8	23.8	794.44
45	SEAT	33.8	23.8	794.44
46	SEAT	33.8	23.8	794.44
47	SEAT	33.8	23.8	794.44
48	SEAT	33.8	23.8	794.44
49	SEAT	33.8	23.8	794.44
50	SEAT	33.8	23.8	794.44
51	SEAT	33.8	23.8	794.44
52	SEAT	33.8	23.8	794.44
53	SEAT	33.8	23.8	794.44
54	SEAT	33.8	23.8	794.44
55	SEAT	33.8	23.8	794.44
56	SEAT	33.8	23.8	794.44
57	SEAT	33.8	23.8	794.44
58	SEAT	33.8	23.8	794.44
59	SEAT	33.8	23.8	794.44
60	SEAT	33.8	23.8	794.44
61	SEAT	33.8	23.8	794.44
62	SEAT	33.8	23.8	794.44
63	SEAT	33.8	23.8	794.44
64	SEAT	33.8	23.8	794.44
65	SEAT	33.8	23.8	794.44
66	SEAT	33.8	23.8	794.44
67	SEAT	33.8	23.8	794.44
68	SEAT	33.8	23.8	794.44
69	SEAT	33.8	23.8	794.44
70	SEAT	33.8	23.8	794.44
71	SEAT	33.8	23.8	794.44
72	SEAT	33.8	23.8	794.44
73	SEAT	33.8	23.8	794.44
74	SEAT	33.8	23.8	794.44
75	SEAT	33.8	23.8	794.44
76	SEAT	33.8	23.8	794.44
77	SEAT	33.8	23.8	794.44
78	SEAT	33.8	23.8	794.44
79	SEAT	33.8	23.8	794.44
80	SEAT	33.8	23.8	794.44
81	SEAT	33.8	23.8	794.44
82	SEAT	33.8	23.8	794.44
83	SEAT	33.8	23.8	794.44
84	SEAT	33.8	23.8	794.44
85	SEAT	33.8	23.8	794.44
86	SEAT	33.8	23.8	794.44
87	SEAT	33.8	23.8	794.44
88	SEAT	33.8	23.8	794.44
89	SEAT	33.8	23.8	794.44
90	SEAT	33.8	23.8	794.44
91	SEAT	33.8	23.8	794.44
92	SEAT	33.8	23.8	794.44
93	SEAT	33.8	23.8	794.44
94	SEAT	33.8	23.8	794.44
95	SEAT	33.8	23.8	794.44
96	SEAT	33.8	23.8	794.44
97	SEAT	33.8	23.8	794.44
98	SEAT	33.8	23.8	794.44
99	SEAT	33.8	23.8	794.44
100	SEAT	33.8	23.8	794.44

THOMAS BUILT BUSES, INC.
PLAN AND ELEVATION
BODY 141YS

DISTRICT PROVIDED INFORMATION:

WILL DISTRICT BE USING FINANCING FOR THIS PURCHASE? YES NO

IF SO, WILL IT BE SCHETKY NW SALES OR DISTRICT COORDINATED? _____

WILL DISTRICT BE TRADING IN ANY VEHICLES? YES NO

IF SO, PLEASE ATTACH COMPLETED "USED BUS INSPECTION REPORT" WHEN ORDER IS PLACED

PLEASE PROVIDE BELTLINE LETTERING (PLEASE LIST YOUR EXACT REQUIREMENTS):

EXAMPLE: "WASHINGTON SCHOOL DISTRICT NO. 123"

PLEASE PROVIDE FLEET NUMBERS (FOR MULTIPLE BUS ORDERS, LIST ALL NUMBERS):

PLEASE CIRCLE DESIRED FLEET NUMBER LOCATIONS ON ENCLOSED "LETTERING REPORT"

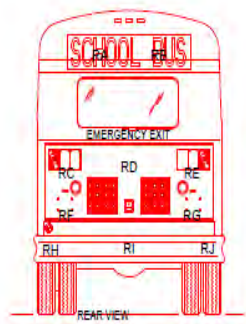
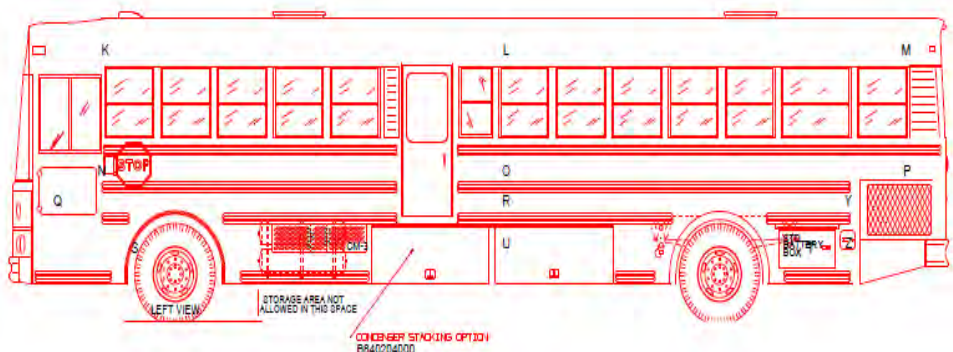

Model: Saf-T-Liner HDX
 Units Ordered: 1
 Order Number: N/A
 Quote Number: 352293
 Locality: WA
 Build Date: N/A

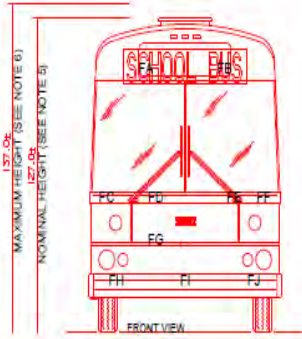
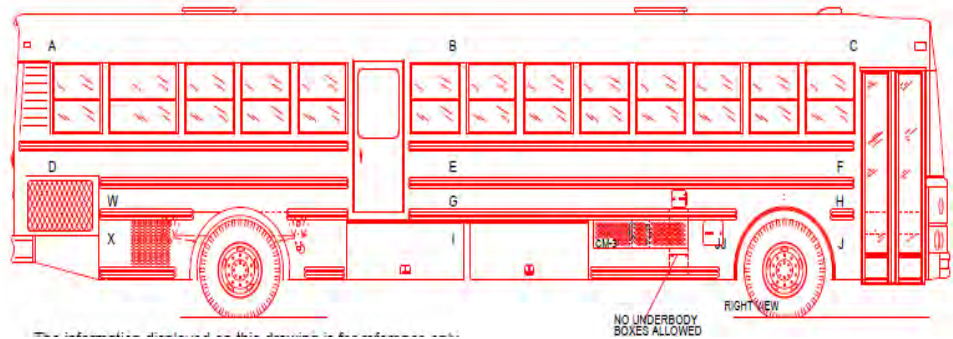

Standard Equipment - Body:

Accessory Switch	50 amp relay circuit board
Assist Rail	Stainless steel step assist rail at entrance door, left side* * Other types optional
Battery Box	Skirt mounted with slide-out tray* *14" high x 25" wide x 16" deep *located left side, rear of rear wheelhouse * Other types optional
Body Panels	Exterior - 20-gauge* Interior - 22-gauge Galvalume from belt line to seat rail * Other types optional
Bumpers	Front and rear - 3/16" thick x 9 3/4" high
Circuit Protectors	Fuses
Color	Exterior - high solids polyurethane Interior - high-baked enamel with flat black trim
Driver's Seat Belt	3-point lap/shoulder belt, black, 175" belt with push-button buckle
Electrical	*Access Covers-Main body wiring harness is easily accessible by removing molded covers sash and the vertical post at the rear of the driver's window. *Accessory Switch-One 50 amp relay circuit board activated by the ignition switch on the chassis. -With the ignition switch on, the relays are activated which allows electrical current to pass through to the body accessories and thereby reduces the amp load on the ignition switch. -With the ignition off, the relays are inactive and no current is allowed to pass. *Circuit Protectors-Fuses *Exterior Electrical/Access Door-Provides easy access to body circuit boards, fuses, relays, and switches -Located below driver's window -Includes flush-ounted, push-button latch with lock *Power Distribution-Through printed circuit technology with LED diagnostic capability. -Located in lockable side electrical compartment below driver's window *Switches-Rocker type, easily serviced *Wiring-Crosslink polyethylene SAE J1128 -All wires passing through metal openings are protected by a grommet -All wiring is color coded and numbered
Emergency Door	Located left side with slide bar lock and buzzer signal.* Includes 4" header pad upholstered with Proform fire block material. * Other types optional
Emergency Window	Located rear with single release handle. Includes 4" header pad upholstered with Proform fire block material.
Entrance Door	Air operated with both leaves opening outward. Includes 4" header pad upholstered with Proform fire block material.
Floor	14 gauge Galvalume
Floor Covering	1/8" smooth rubber with 3/16" ribbed aisle. Steps ribbed with white nosing
Fuel Tank Opening	Exterior - hinged door with latch Interior - access plate in floor for servicing
Guard Rails	One 4 1/4" applied below windows One 4 1/4" applied at seat cushion level One 4 1/4" applied at floor level One 4 1/4" applied at skirt bottom Two 2 15/16" applied at roof extending length of passenger compartment
Heater	90,000 BTU defroster/heater with air management system located center front. Includes booster pump located in engine compartment. Fan motor, heater core, and filter on slide out trays which are serviceable from the front exterior access panel.
Insulation	2" thick thermalbonded polyester fiber insulation in headlining, side, rear and front cowl. R-value 6 (nominal). Galvalume enclosing thermalbonded fiber insulation in engine compartment area. Interior davenport seat and shelf covered with 1/2" sound deadener and insulation.
Interior Mirror	6" x 30"* * Other types optional
Lettering	Vinyl block style letters
Lights	Back-up - two (2) with clear lens Cluster Three (3) amber dual bulb light mounted on upper front body hood. Three (3) red dual bulb light mounted on upper rear body hood Directional* Front - two (2) recessed 7" round plain amber Side - two (2) plain amber Rear - two (2) 7" round plain amber Dome - ten (6) minimum Engine Compartment (Interior) - two (2) with protective lens Headlights - Halogen dual sealed beam recessed. Amber "Day Time" Running lights. Marker - two (2) front corners, rear corners and amidship side roof (dual bulb) Stepwell - quantity one (1) Stop/Tail - 7" plain red dual element and 4" plain red mounted one (1) left and one (1) right* * Other types optional
Reflectors	Eight (8) round, three (3) each side and two (2) rear
Rustproofing	Primer applied to both sides of all painted steel panels prior to assembly
Safety Switch	Located in the engine compartment and activated when rear engine door is open to prevent the driver from starting the engine when door is open
Service Access Panels	Three (3) piece composite access panel located beneath windshield providing access to front heater system, wiper motors, air brake plumbing, washer bottle, horns, electrical connections and steering shaft. Exterior electrical access panel located below driver's window for servicing the body electrical system. Interior electrical access panel located on the right side of dash for servicing the chassis electrical system.
Stepwell	Three (3) steps
Storage	Compartment located over windshield with quick-release latches
Sun Visor	6" x 30" mounted to windshield header* * Other types optional
Switch Panel	Mounted left of driver with switches for electrical equipment with LED back-lighting
Undercoating	Floor, skirts and wheelhouses
Ventilator	Fresh air vent intake for driver's feet area Static exhaust located in roof
Windows	Driver's - tempered glass with double sliding aluminum sash with latch Side - tempered glass with split aluminum sash* * Other types optional
Windshield	2-piece continuous curved tinted safety plate laminated glass Two (2) assist handles: one (1) mounted above center of each glass
Windshield Washer	One (1) gallon capacity
Windshield Wipers	Parallelogram wet arm type, 2-speed
Wiring Harness	Main body harness is color coded and numbered

Standard Equipment - Chassis:

Air Cleaner	Donaldson, dry type, single stage
Axles	Front - 13,200 lb. axle rating I-beam type, with greasable tierod ends* Other types optional * Other types optional
Brakes	Parking - dash mounted control valve with spring set release Air compressor - gear driven Air Reservoirs - with pressure protection valve on wet tank and manual drain valve on each tank Air Lines color-coded for easy identification
Cooling System	Aluminum construction Expansion tank with clear sight glass Radiator, CAC, external mounted in tandem Aluminum CAC, 30" diameter, 9-blade fan, mechanical fan drive
Crossmembers	Combination of stamped and fabricated
Electrical Controls and Instruments	Dash Mounted Dual air gauge PSI Electric driven speedometer in MPH/KPH Fuel gauge Headlight switch High/low beam indicator Ignition switch Low air buzzer and light Oil pressure gauge Low or High Tachometer Voltmeter Water temperature gauge Cold or Hot Steering Column Mounted Self-canceling combination turn signal High beam switch Horn Four-way flasher Engine Compartment Ignition on-off toggle safety switch Starter button Master Fuse Junction Block with (2) 175 amp fuses and (1) 150 amp fuse Compartment light switch and (2) compartment lights with protective lens
Electrical System	12-volt, negative ground
Exhaust System	Single ATD with 4" tailpipe exiting below the bumper RH side* * LH optional DD8: DPF/SCR with decomp pipe, 4" tailpipe exiting below the bumper RH side * LH optional
Horn	Dual Electric
Oil Filter	Full flow, spin-on
Shock Absorbers	Front - Four (4) direct acting, double action, piston type Rear - Two (2) direct acting, double action, piston type
Springs	Front - 4" x 66" single stage taperleaf Rear - Must be ordered by option number
Steering	18" diameter steering wheel with tilt/telescoping column * Douglas Autotech model 900 with 20.4:1 ratio
Wiring	Color coded and numbered



August 21, 2019

Elizabeth Sanchey
Program Manager
Yakama Nation Environmental Management Program
Toppenish, Washington

Re: VW Round 2 Fee Request

Dear Ms. Sanchey:

The Askman Law Firm, L.L.C. is pleased to have had the opportunity to assist the Yakama Nation with their application for the second round of VW trust funds. This letter serves as the Firm's fee request to be submitted as part of the Yakama Nation's application. The Firm is requesting a fee to be funded as an eligible administrative expense with trust funds the Yakama Nation receives. The Firm is requesting a fee for the Firm's services already provided, along with an estimated fee based on the services the Firm anticipates providing following approval of the application. These fees will be in addition to any trust funds received by the Yakama Nation.

As you are aware, the Firm informed the Yakama Nation of their eligibility to become a beneficiary under the Trust Agreement. The Firm also advised the Yakama Nation on how they could benefit from becoming a beneficiary, including providing the Yakama Nation with an analysis of the amount of funds the Yakama Nation should receive from the trust and preparation of an application strategy to maximize that value for the Yakama Nation. When the Yakama Nation decided to apply to become a beneficiary and apply for trust funds, the Firm assisted the Yakama Nation in preparing its applications for the first and second rounds.

The Firm is submitting its fee request to be paid from trust funds awarded to the Yakama Nation as an eligible administrative expense under the Trust Agreement. Appendix D-2 to the Trust Agreement includes a section for "Eligible Mitigation Action Administrative Expenditures." That section permits the Yakama Nation, as a Beneficiary, to "use Trust Funds for actual administrative expenditures (described below) associated with implementing such Eligible Mitigation Action, but not to exceed 15% of the total cost of such Eligible Mitigation Action." That section goes on to describe eligible administrative expenditures to include, *inter alia*, "[c]ontractual including all contracted services," "[c]ontracts for evaluation and consulting services," and "[o]ther costs including ... professional services." It also specifies certain items that do not qualify as eligible administrative expenditures, including fees prior to October 2, 2017 and any expenses in preparing an

Elizabeth Sanchey

August 21, 2019

Page 2 of 2

Appendix D-3. The services that the Firm provided to the Yakama Nation in preparing its application, as well as the services that the Firm will provide to the Yakama Nation in implementing its project, qualify under those provisions and the guidance provided by the Trustee and the U.S. Department of Justice.

As of the time of this Fee Request, the Firm is requesting a fee of \$3,465.00 for 9.9 hours spent assisting the Yakama Nation with their application for VW second round trust funds. Additional detail is provided in the attached invoice, including a description of the person who worked on the matter, the date of the work, the time spent on the task, the task performed, and the hourly rate.

The Firm estimates that any future assistance provided to the Yakama Nation in implementing the project will cost take about \$7,000.00, based on 20 hours at \$350 per hour. We estimate the hours based on performing the following tasks: 1 hour for contracting and purchase of the new buses; 1 hour for arranging for rendering the old buses inoperable; 15 hours for preparation of status reports on the project; and 3 hours for closing out the project including preparation of a final report.

Thank you for your prompt attention to this matter. Please contact me at (720) 407-4331 or email me at michael@askmanlaw.com if you would like to discuss the contents of this letter in more detail.

Very truly yours,

s/ Michael M. Frandina

Michael M. Frandina, Esq.
THE ASKMAN LAW FIRM, LLC
1543 Champa Street, Suite 400
Denver, CO 80202

Enc. Invoice 1443 for Application Fee

The Askman Law Firm, LLC
 The Odd Fellows Hall1543
 Champa Street, Suite 400
 Denver, CO 80202
 www.askmanlaw.com



Invoice

BILL TO
Yakama Nation - VW Settlement Round 2 PO Box 151 Toppenish, Washington 98948 United States

INVOICE #	DATE	TOTAL DUE	DUE DATE	ENCLOSED
1443	08.21.2019	\$3,465.00	12.13.2019	

DATE	ACTIVITY	QTY	RATE	AMOUNT
03.22.2019	Hours Prepare estimate for round 2 allocation for planning purposes, including preparing spreadsheet with the 67 tribes that may participate and an allocation assuming each tribe does participate, and send email to Ethan Jones and Elizabeth Sanchey regarding same (1.2) - Mr. Michael M. Frandina Esq.	1:12	350.00	420.00
06.03.2019	Hours Email Elizabeth Sanchey and Ethan Jones regarding D-6 forms and accounting tracking (0.1) - Mr. Michael M. Frandina Esq.	0:06	350.00	35.00
06.10.2019	Hours Email Ethan Jones and Elizabeth Sanchey regarding status of D-6 forms (0.1) - Mr. Michael M. Frandina Esq.	0:06	350.00	35.00
06.11.2019	Hours Email Ethan Jones and Elizabeth Sanchey regarding confirmation of D-6 forms (0.1) - Mr. Michael M. Frandina Esq.	0:06	350.00	35.00
07.08.2019	Hours Email Elizabeth Sanchey about Round 2 allocation (0.1) - Mr. Michael M. Frandina Esq.	0:06	350.00	35.00
07.22.2019	Hours Review Yakama Nation Round 2 allocation letter setting forth \$394,215 as the funding amount (0.1); revise Round 2 budget from initial estimates to look at options including replacing 3 buses versus 2 (0.3); draft email to Ethan Jones and Elizabeth Sanchey regarding Round 2 project including options of 2 versus 3 buses (0.3); forward email to Ethan Jones and Elizabeth Sanchey about Head Start buses and draft request for additional information on said buses (0.2) - Mr. Michael M. Frandina Esq.	0:54	350.00	315.00
08.01.2019	Hours Email Ethan Jones and Elizabeth Sanchey regarding	0:42	350.00	245.00

DATE	ACTIVITY	QTY	RATE	AMOUNT
08.05.2019	Round 2 replacement vehicles from the Head Start program (0.1); call with Terry Ganuelas about Head Start buses (0.1); call with Terry Ganuelas about needing scale weight or GVWR (0.1); call with Terry Ganuelas about GVWR results (0.1); review email from Terry Ganuelas with GVWR for other Head Start buses (0.1); and email Yakama Nation regarding eligible vehicle and desired replacement for it (0.2) - Mr. Michael M. Frandina Esq. Hours	0:06	350.00	35.00
08.06.2019	Correspondence with Elizabeth Sanchey about revised D-4 form (0.1) - Mr. Michael M. Frandina Esq. Hours	0:12	350.00	70.00
08.09.2019	Email correspondence with Ethan Jones update on VW matters including Round 2 issues about proposed project (0.1); and email Elizabeth Nason regarding VW project (0.1) - Mr. Michael M. Frandina Esq. Hours	2:30	350.00	875.00
08.14.2019	Prepare Round 2 d-4 application for the VW project, including preparing the budget and updating the application form and send to Ethan Jones and Elizabeth Sanchey for review (2.5) - Mr. Michael M. Frandina Esq. Hours	0:30	350.00	175.00
08.15.2019	Email Ethan Jones and Elizabeth Sanchey about second round application form (0.1); review email from Elizabeth Sanchey approving initial draft (0.1); view forwarded email from Elizabeth Sanchey regarding ITEP vehicle inventory and review blank vehicle inventory form (0.2); and forward second round D-4 form to Sara Wagner for review (0.1) - Mr. Michael M. Frandina Esq. Hours	0:36	350.00	210.00
08.19.2019	Review email response from Sara Wagner regarding receipt of draft D-4 submission (0.1); review forwarded email from Elizabeth Sanchey from Trustee (0.1); exchange's email with Sara Wagner regarding Section 9 subsection (0.1); email from Ethan Jones approving draft (0.1); review email (but not attachment) from Sara Wagner with comments to draft D-4 attached (0.1); and review email from Sara Wagner regarding bus accessories (0.1) - Mr. Michael M. Frandina Esq. Hours	1:42	350.00	595.00
08.20.2019	Revise D-4 application (including budget overhaul) based on input from Sara Wagner and resubmit for second review (1.7) - Mr. Michael M. Frandina Esq. Hours	0:12	350.00	70.00
08.21.2019	Email correspondence with Sara Wagner and Mark Daniels regarding a few D-4 issues (0.2) - Mr. Michael M. Frandina Esq. Hours	0:54	350.00	315.00
	Prepare final D-4 application packet including copy editing draft, complying with all comments from technical advisor, and reviewing trust agreement, and			

DATE	ACTIVITY	QTY	RATE	AMOUNT
	send to Elizabeth Sanchey and Ethan Jones for signing (0.9) - Mr. Michael M. Frandina Esq.			

VW Round 2 application

BALANCE DUE

\$3,465.00